

ASSEMBLY, OPERATING INSTRUCTIONS
AND PARTS LIST FOR
SEARS
DRAG HARROW
FOR SEARS CUSTOM, SUBURBAN
AND HYDRO-TRAC TRACTORS

Sears

MODEL NUMBER
917.251230

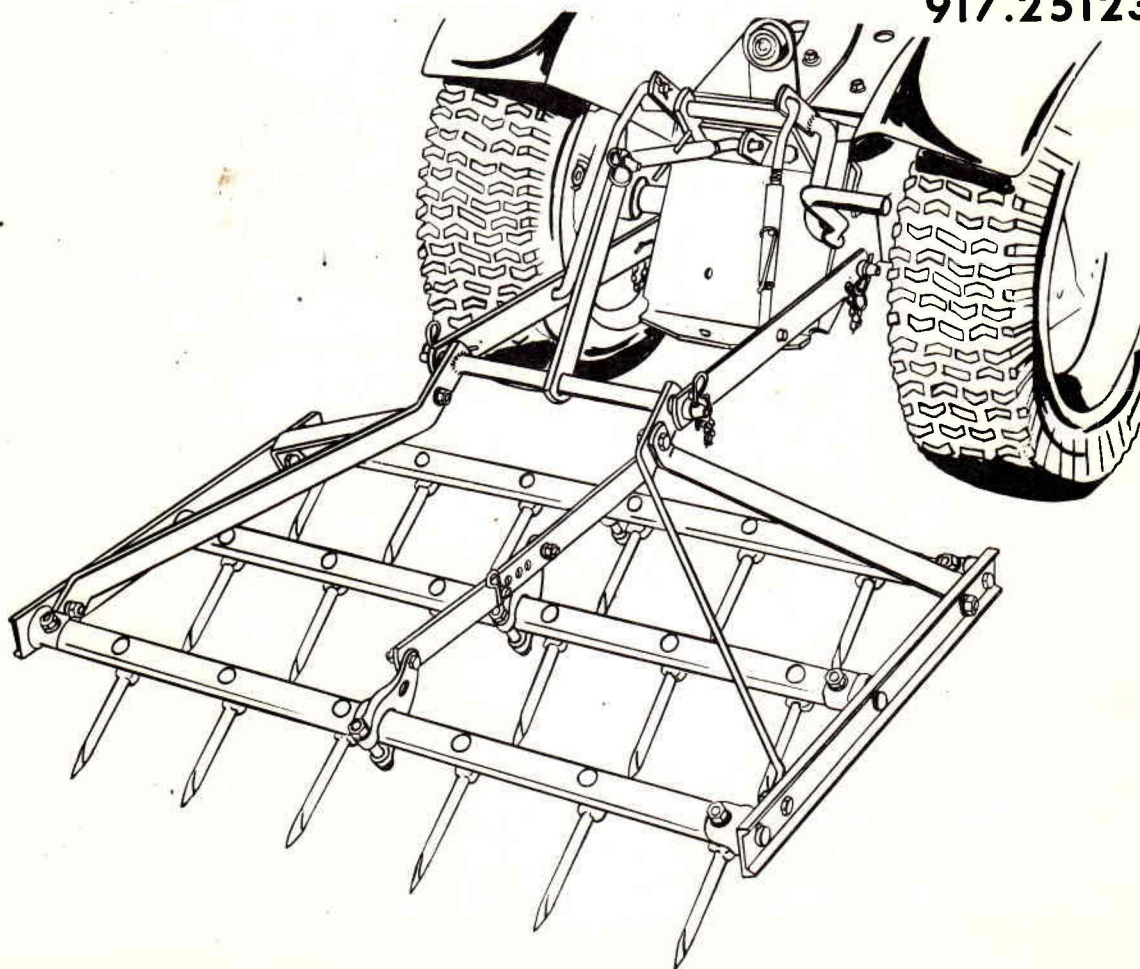

SEARS, ROEBUCK AND CO.—U.S.A.

SIMPSONS-SEARS LIMITED — CANADA

8971H

PRINTED IN U. S. A.

INTRODUCTION

Your Drag Harrow was designed expressly to fill the needs of the small acreage farmer and gardener. Its principal use is dragging, leveling and preparing soil for a fine seed bed prior to planting.

Harrow in alternate directions for best seed bed. Deep penetration is accomplished by adjusting the angle of the teeth. This Drag Harrow can be used on all jobs and purposes for which a large Harrow is used, and will accomplish equivalent results.

Sears, Roebuck and Co. or Simpsons-Sears Limited reserves the right to make any changes in design or improvements without imposing any obligation to install the same upon its implements heretofore manufactured.

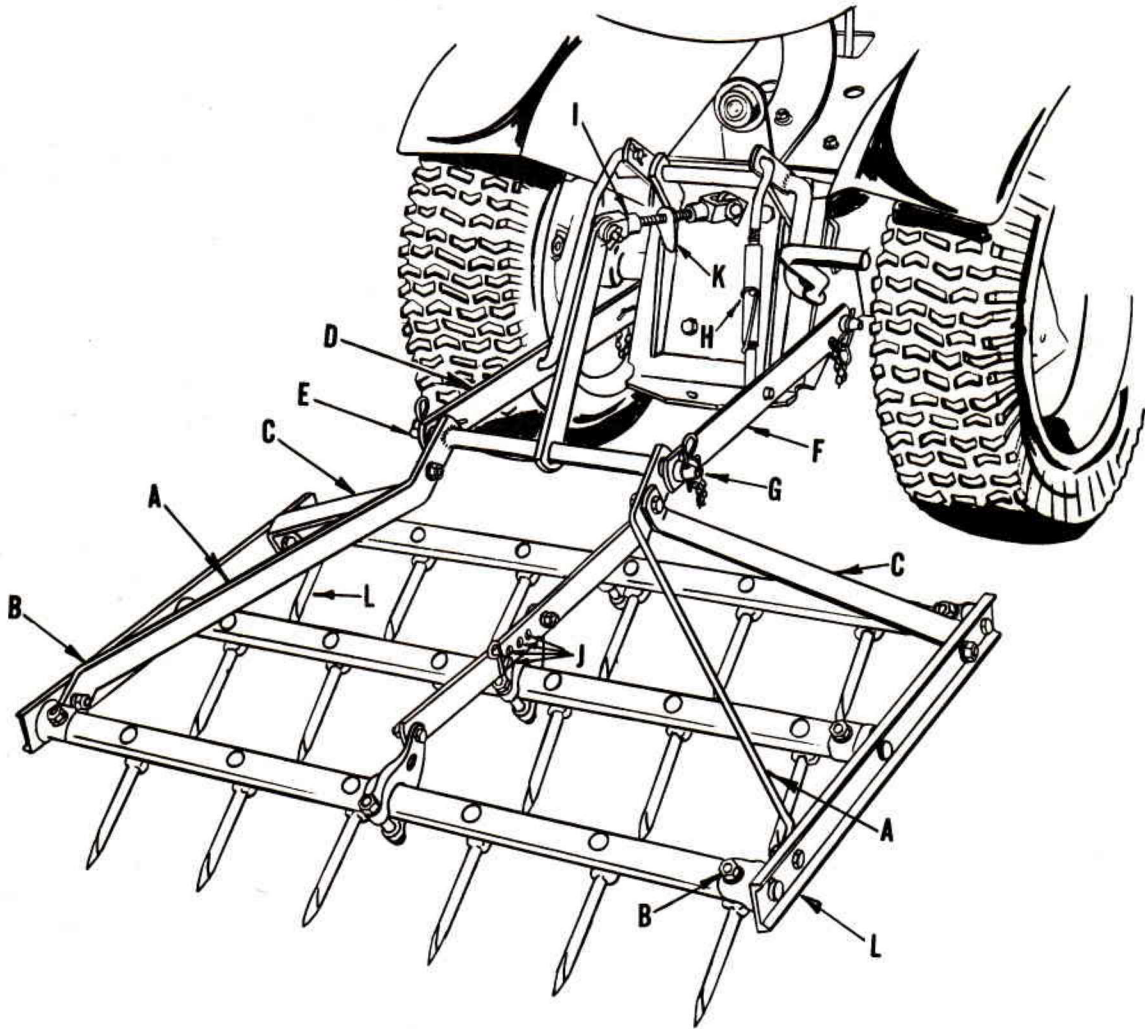

Setting Up and Operating Instructions should be studied very closely before beginning to assemble your Drag Harrow.

SETTING UP INSTRUCTIONS

A number in the following instructions refers to an arrow in the drawing on page 2. When R.H. (Right Hand) or L.H. (Left Hand) are used, it should be understood to mean from a position behind and facing the Drag Harrow or direction of travel.

1. Cut all wires.
2. Remove bolt, nut and lockwasher from both unassembled ends of frame (A). Secure frame (A), to side rails (B), both R.H. and L.H. sides with bolts, nuts and lockwashers removed above.
3. Remove bolt, nut and lockwasher from both unassembled ends of front drawbar straps (C). Secure front drawbar straps (C), to frame (A), with bolts, nuts and lockwashers removed above.

INSTRUCTIONS FOR ASSEMBLING DRAG HARROW TO TRACTOR

4. Refer to Three Point Hitch Instruction Book for assembling Three Point Hitch to Tractor.
5. Back Tractor into position to attach Drag Harrow. Slip L.H. link (D), over L.H. link pin (E), on Drag Harrow and secure with spring retainer.
6. Slip R.H. link (F), over R.H. link pin (G), on Drag Harrow and secure with spring retainer.
NOTE: R.H. lift link is adjustable. Rotate turnbuckle (H), so that R.H. bottom link (F), slides over R.H. link pin (G), on Drag Harrow easily.
7. Assemble top link (I), to Drag Harrow frame (A), as shown and secure with spring retainer.

OPERATING INSTRUCTIONS

ANGLE OF TEETH

There are four positions (J), for angling the teeth as shown. Adjust the teeth to the position desired by removing retainer spring and inserting adjusting link in desired hole. Replace retainer spring.

LEVELING DRAG HARROW

There is a turnbuckle on the linkage of the Three Point Hitch for leveling the Drag. The turnbuckle (H), on the R.H. lift link is used for leveling the Drag from side to side. Adjust R.H. lift link so that the teeth of the Drag Harrow touch level surface at the same time. Rotate turnbuckle from left to right to lengthen linkage.

When harrowing, adjust the clevis (I), so that the frame of the Drag Harrow is parallel with the ground from front to rear. Rotate adjusting screw (K), to the right (clockwise), to lengthen the top linkage.

NOTE: It is possible that the front of the Harrow should be a little higher than the rear for clearing trash, etc.

MAINTENANCE AND SERVICE INSTRUCTIONS

During the operating season, check all bolts and nuts and keep them tight. When replacement teeth are ordered, they will come equipped with bolt, nut and lockwasher. Remove the teeth from the tooth bar (teeth are all riveted except as shown at L), and replace all teeth with bolt, nut and lockwasher (bolt head against tooth). Be sure the tooth bar fits into the groove on the tooth. For convenience, the tooth bar may be removed.

SEARS DRAG HARROW -- MODEL NUMBER 917.251230

WHEN ORDERING REPAIR PARTS, ALWAYS GIVE THE FOLLOWING INFORMATION AS SHOWN IN THIS LIST:

1. The PART NUMBER.
2. The PART NAME.
3. The MODEL NUMBER -- 917.251230.
4. The NAME OF ITEM -- DRAG HARROW.

Do not use the Key Number when ordering repair parts, always use the Part Number. The Model Number will be found on a plate attached to the Hitch Bar of the Frame, Key Number 1, below.

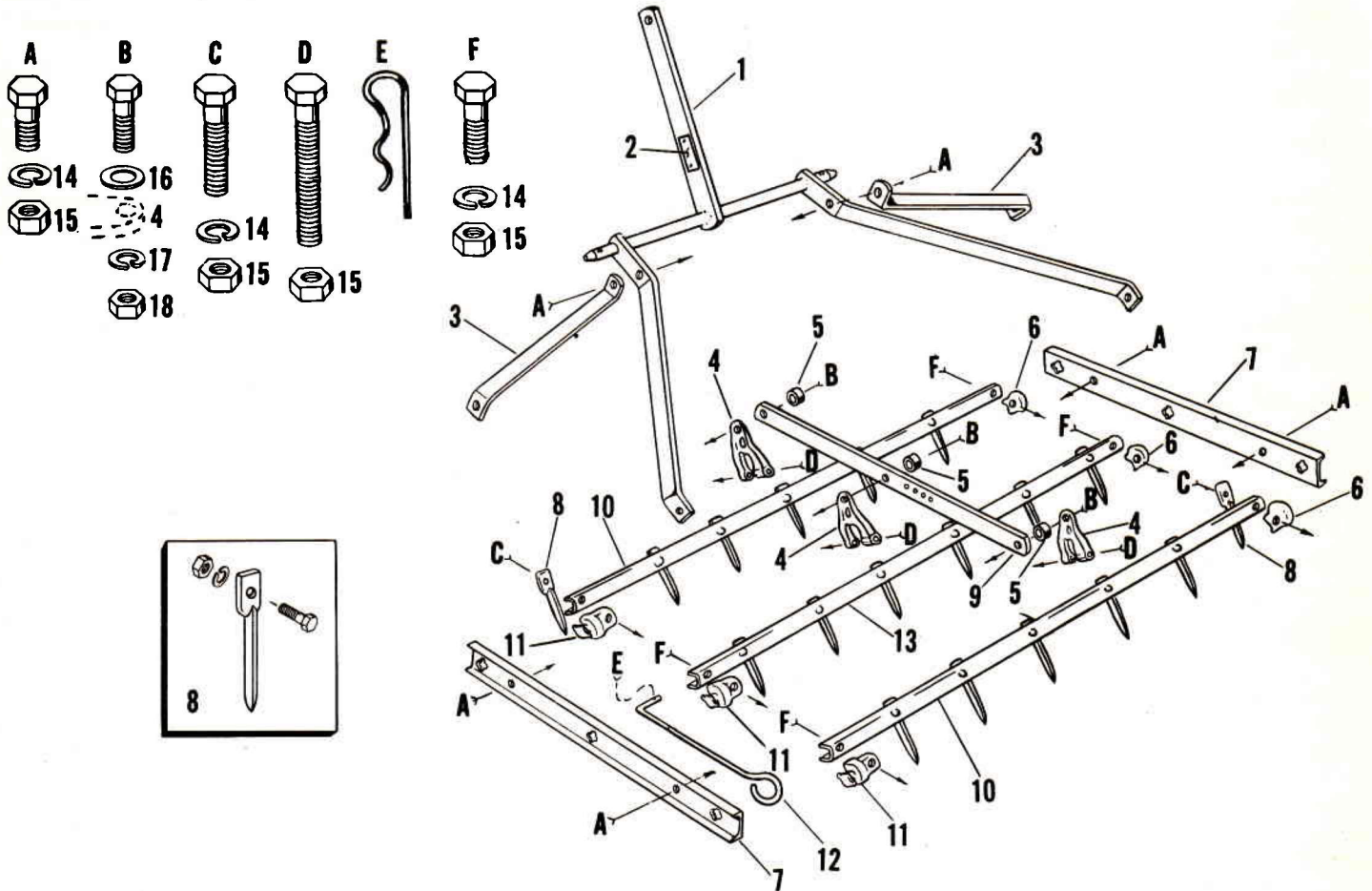

PARTS LIST

Key No.	Part No.	Description	Key No.	Part No.	Description
1	606A47	Frame	14	103322	*Washer, Lock 7/16
2	----	Model Number Plate	15	271500	*Nut, Hex 7/16 ASRU-14 NC
3	1384H	Front Drawbar Strap	16	103341	Washer, Flat 13/32 x 13/16 x 16 Ga.
4	8969H	Tooth Bar Lever Arm	17	103321	*Washer, Lock 3/8
5	4358M	Bushing	18	102635	*Nut, Hex 3/8 ASRU-16 NC
6	4352M	Tooth Bar Ferrule - R.H.	A	100146	Bolt, Hex Hd. 7/16 x 1 ASRU-14 NC
7	1387H	Side Rail	B	100135	Bolt, Hex Hd. 3/8 x 1 1/4 ASRU-16 NC
8	574PA24	Tooth, Bolt, Nut and Lock Washer	C	106338	Bolt, Hex Hd. 7/16 x 2 1/4 ASRU-14 NC
9	1385H	Drag Link	D	100152	Bolt, Hex Hd. 7/16 x 3 ASRU-14 NC
10	8967H	● Tooth Bar	E	4939M	Retainer Spring
11	4353M	Tooth Bar Ferrule - L.H.	--	8971H	Instruction and Parts Book
12	1383H	Adjusting Link	F	100147	Bolt, Hex Hd. 7/16 x 1 1/4 ASRU-14 NC
13	8968H	● Tooth Bar Center			

●Teeth not included

*Standard Hardware Item - may be purchased locally.