

Sears
owners
manual

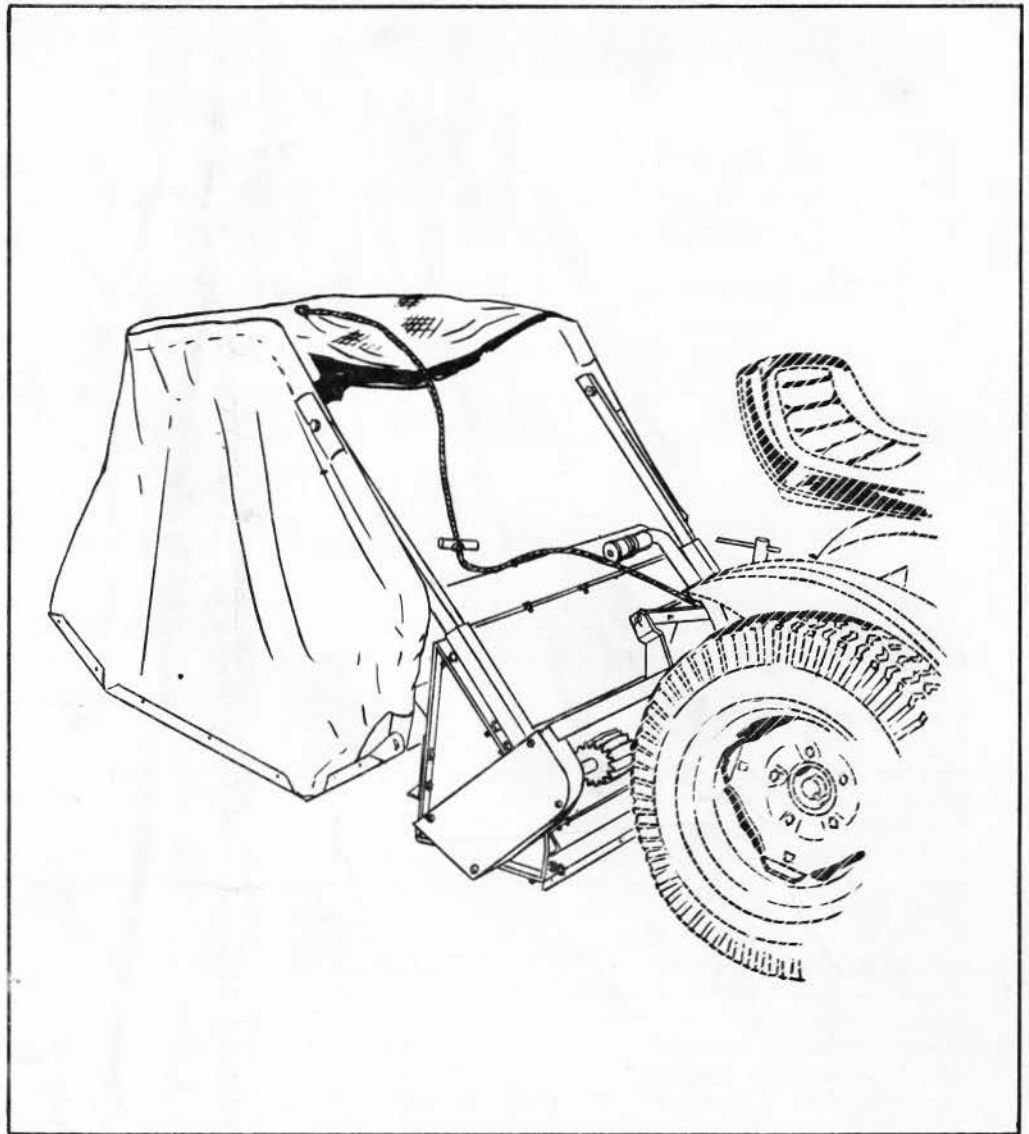

MODEL NO.
917.253440

LITTER-WHISK

- Assembly
- Operating
- Maintenance
- Repair Parts

Sears, Roebuck and Co., Chicago, Ill. 60607 U.S.A.
and Simpsons Sears Limited, Toronto

GUARANTEE

During the first year, we will repair your attachment free of charge if found defective in material or workmanship. This guarantee service is available by simply contacting any of our stores or service centers throughout the United States or Canada.

The guarantee is limited to 30 days if the item is used for commercial purposes.

SEARS, ROEBUCK AND CO. - SIMPSONS-SEARS LIMITED

IMPORTANT rules for safe operation

Operator should become fully familiar with all the different sections of this Owners Manual and the Tractor Manual before attempting to operate Tractor and Litter-Whisk. Know the controls and how to stop quickly. Do not start or operate Tractor and Litter-Whisk when not in driver's seat.

introduction

This Product has been designed, engineered and manufactured to give you the best possible dependability and performance.

Should you experience any problem you cannot easily remedy, please contact your nearest Sears, Roebuck or Simpsons-Sears, Ltd. Store. They have well qualified, competent trained technicians and the proper tools to service or repair this unit.

It is important that the operator ALWAYS OBSERVES THE "RULES FOR SAFE OPERATION" as well as other instructions contained in this Manual and the Tractor Manual.

We have provided this Manual to help you operate your Litter-Whisk with utmost efficiency. We urge you to study this Manual so you will understand your new Litter-Whisk thoroughly before operating it. We suggest that you take care of your Manual so that it will be available for future reference should you need it.

assembly

A letter in parentheses in the following instructions refers to an arrow in the adjoining Figure (Illustration), except when otherwise stated. When R.H. (Right Hand) or L.H. (Left Hand) is used, it should be understood to mean as if one were seated on the tractor seat facing forward.

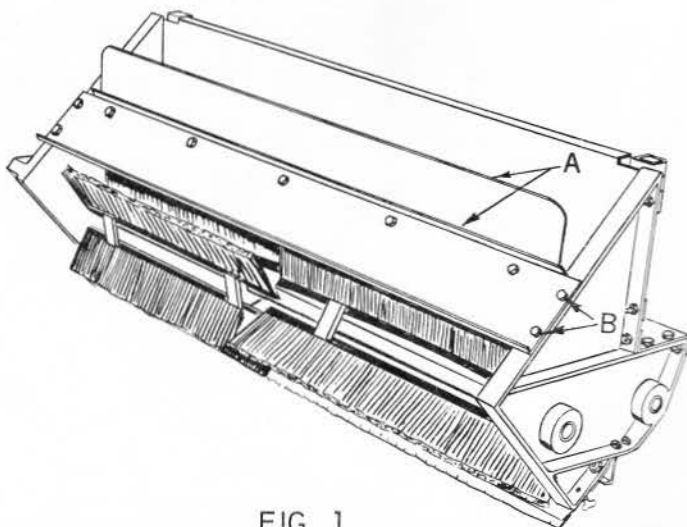

FIG. 1

1. Start with assembly of parts in carton number 1 first. Remove all parts from carton and open bag of hardware. Save the two $\frac{1}{4}$ inch Gripco nuts, two $\frac{1}{4} \times 2\frac{1}{2}$ inch hex bolts and six $\frac{9}{32} \times \frac{1}{2}$ flat washers. They will be used to assemble the catcher, top of page 3.
2. Locate the sweeper throat extension and the rear channel (A), which are bolted together. From the bag of hardware, pick out the four hex bolts $\frac{1}{4}'' \times \frac{3}{4}''$, four $\frac{1}{4}''$ hex nuts and four $\frac{1}{4}''$ lockwashers.
3. Position the sweeper throat extension and the rear channel (A), to rear of sweeper with throat extension at the top as shown. Put bolts (B), through rear channel and then through castings. Secure with lockwashers and nuts.

assembly (cont.)

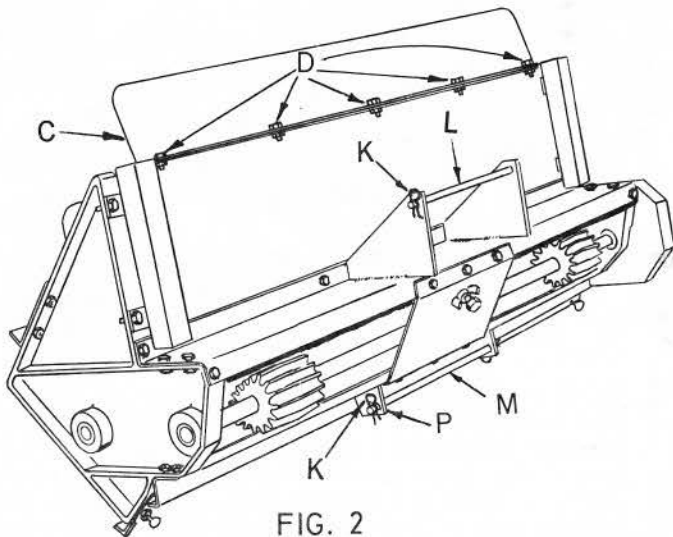

FIG. 2

- From the bag of hardware, pick out the five hex bolts $\frac{1}{4}'' \times \frac{3}{4}''$, five $\frac{1}{4}''$ hex nuts and five $\frac{1}{4}''$ lockwashers. Secure discharge guide panel (C), to lip of main panel of sweeper above brush opening with hardware (D), mentioned above. Install with lip of discharge guide panel (C), upward against lip of main sweeper panel as shown.

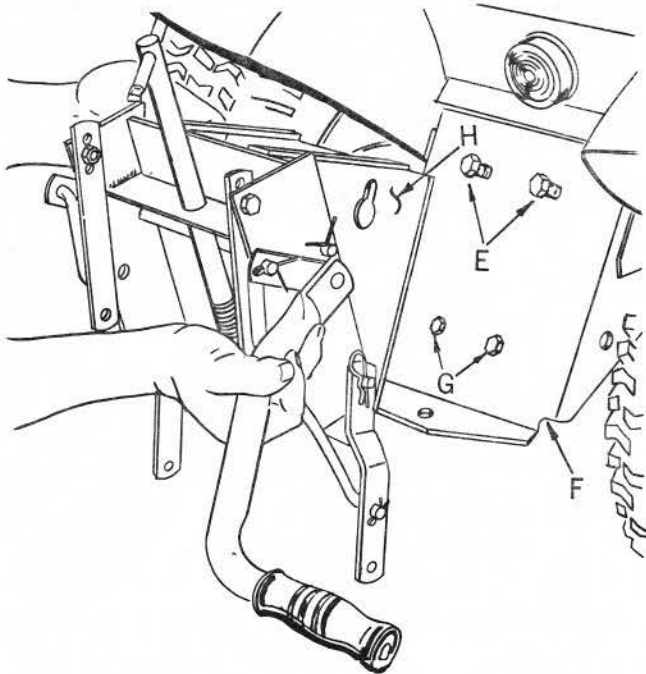

FIG. 3

- Start two $\frac{1}{2}'' \times 1\frac{1}{4}''$ hex bolts (E), (shipped in bag of hardware), into the two top holes in tractor drawbar (F). NOTE: These two top holes have nuts welded to the underside of drawbar. Do not tighten.
- Insert a $\frac{3}{8}'' \times 1\frac{1}{4}''$ hex bolt (G), into the two bottom holes of tractor drawbar (F). Position a $\frac{3}{8}''$ lockwasher and a $\frac{3}{8}''$ plain hex nut on each of the two hex bolts (G), on underside of drawbar (F). Do not tighten. Hardware shipped in bag.
- Grasp sweeper hitch unit as shown and position the four slots in hitch plate (H), over the heads of the four bolts (E and G).

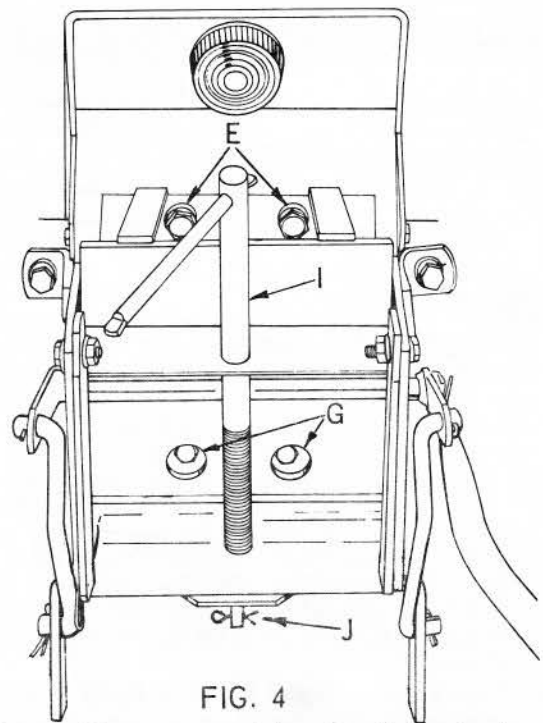

FIG. 4

- Raise lift screw and handle (I), and place a $\frac{13}{32} \times \frac{13}{16}$ flat washer over the hole on tractor drawbar. Lower lift screw and handle (I), so that lift screw enters hole in washer and hole in tractor drawbar. Place the other $\frac{13}{32} \times \frac{13}{16}$ flat washer over lift screw beneath drawbar and secure with cotter pin (J). Washers and cotter pin shipped in bag of hardware. Tighten the four bolts (E and G, Fig. 3), securely. Check to see that lift screw (I), turns freely.
- Refer to Fig. 2. Remove retainer springs (K), and rods (L and M), from ends of upper and lower lift links.

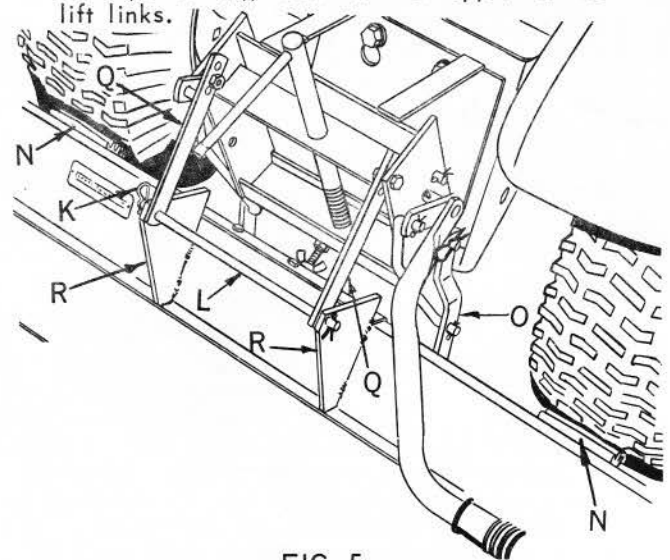

FIG. 5

- Move sweeper unit behind tractor and position so that drive rollers (N, Fig. 5), are at the front, near the top. For ease in assembly of lift links (O and Q), tilt sweeper back.
- Line up lower lift links (O, Fig. 5), with lower lift brackets (P, Fig. 2),--links to outside of brackets, and insert longest rod (M, Fig. 2). Secure with retainer spring (K, Fig. 2).
- Line up upper lift links (Q), with holes in upper lift brackets (R), and insert rod (L). Secure with retainer spring (K). Lift links should be inside lift brackets.

assembly (cont.)

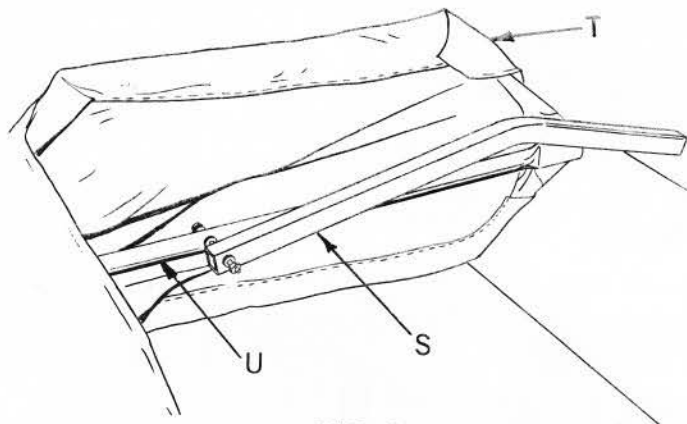

FIG. 6

13. Open carton number 2. Remove catcher (T), from shipping carton and lay catcher on carton. The following steps will use the balance of the hardware shipped in plastic bag and in carton number 1.
14. Two support tubes (S), are taped inside the catcher (T), and should be removed at this time. The tubes (S), should be mounted on pivot tubes (U), on the inside with bend directed downward. Put the hex bolt in from catcher bag side with a washer between and on each side of tubes (U). Do not tighten securely. Draw nut up to eliminate play, but tubes must be free to pivot.

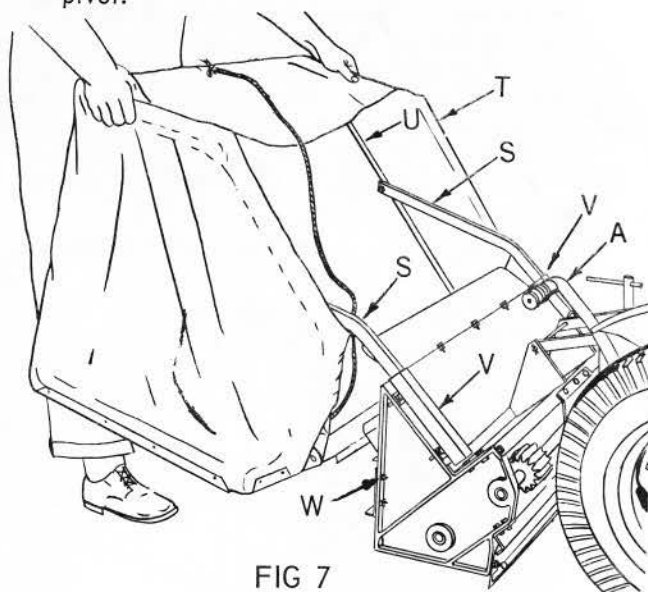

FIG 7

15. Sweeper catcher (T), is attached to sweeper unit by inserting support tubes (S), into brackets (V), at each end of sweeper unit. Insert support tubes into brackets and slide until tubes reach bottom.
16. Sweeper catcher should now pivot freely WITH LEADING EDGE OF BOTTOM OF CATCHER BELOW UPPER FLANGE OF REAR CHANNEL (W), ON SWEEPER.

CORRECT TIRE PRESSURE IS VERY IMPORTANT. REFER TO TRACTOR OWNERS MANUAL OR MAINTENANCE REMINDER LOCATED ON UNDERSIDE OF TRACTOR HOOD.

sweeping height adj.

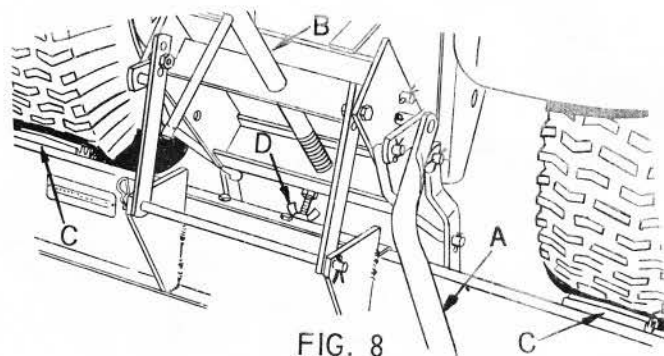

FIG. 8

The sweeper is raised or lowered by means of the lift lever (A, Fig's. 8 and 9). Pushing lever rearward lowers the sweeper and engages the drive when rollers contact the tractor tires. This causes the brush to rotate, throwing the material into the catcher basket. Pulling up on the lever raises the sweeper into the transport position. This action also disengages the drive rollers from the tractor tires, stopping the brush. It is recommended that the sweeper be in the raised position when backing up.

The sweeping height is adjusted with the lift screw and handle (B, Fig's. 8 and 9). Turning the handle clockwise will lift the sweeper. Turning the handle counter-clockwise lowers the sweeper. Initial sweeping height is adjusted as follows:

1. Park tractor and sweeper on a flat surface (sidewalk, driveway, garage floor, etc.). Set sweeper in lowered position with drive rollers (C, Fig. 8), against tires.

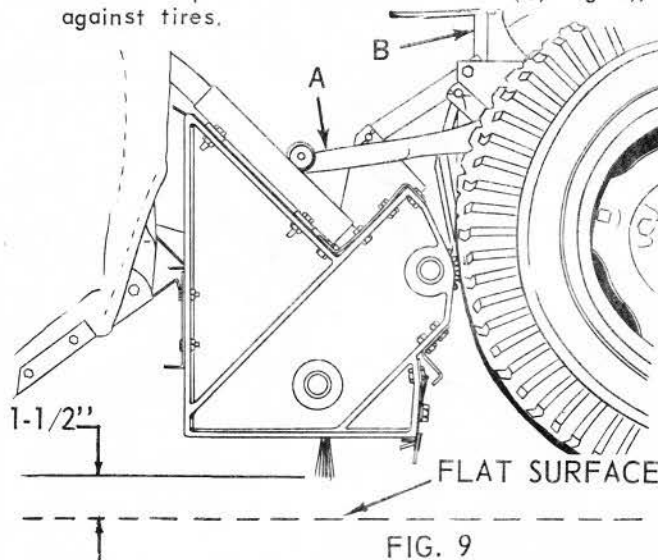

FIG. 9

2. Raise or lower sweeper until the tip of the brush is about 1 1/2 inches from the flat surface. The brush may have to be rotated until the brush section on either end is pointing straight down. The amount of adjustment needed depends on the tractor to which the sweeper is attached and the size tires on the tractor.

operating (cont.)

tire-drive roller contact pressure

1. Before you operate the sweeper, you should adjust the stop for tire-drive roller contact. This is the bolt with the wing nut (D, Fig. 8), located on the sweeper body between the lift arms.
2. The sweeper should be in the lowered position with the drive rollers (C, Fig. 8), against the tractor tires. Loosen the wing nut and turn the bolt in or out until the head of the bolt is about 1/8 inch away from the stop on the hitch. At this point, tighten the wing nut securely.
3. When the sweeper catcher is full of material such as wet grass clippings, the stop will prevent the buildup of too much tire-drive roller contact pressure.

for picking up cut grass, leaves, twigs, etc.

1. Final adjustments can now be made as you operate the sweeper. If the brush is leaving material on the lawn (where the lawn is level), the sweeper should be lowered. If the sweeper appears to be dragging to the extent that the rollers slip on the tractor tires, (where the lawn is level), the sweeper should be raised. Adjust the height until sweeping is satisfactory on a level lawn.

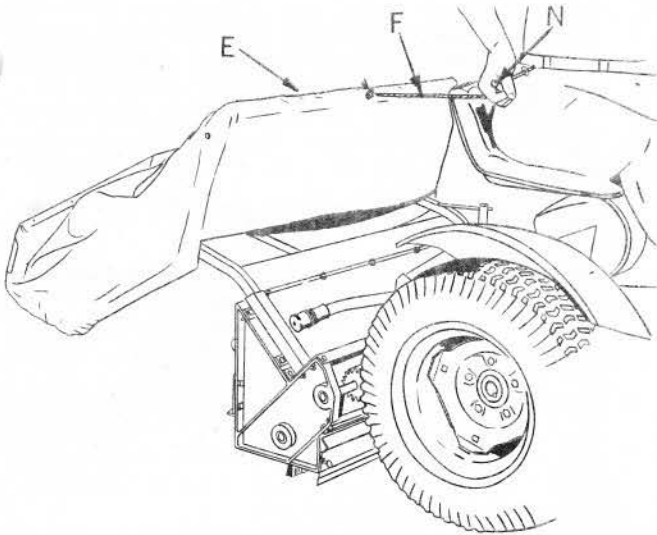

FIG. 10

operating catcher basket

1. The catcher basket (E), is dumped by pulling on the rope (F), attached to the rear of the catcher. This rope can be adjusted in the following manner: Move the wooden handle back to the center of the rope and put a knot in the rope to position the handle. Sit on the tractor seat and reach back to grasp the handle (N, Fig. 10). Adjust the position of the handle along the rope at the most comfortable position when reaching for it. Take the end of the rope and drape it around the lift screw and handle (B, Fig. 9), below the handle and make a slip knot. This will prevent the rope from falling into the catcher and interfering with the deposit of material. Remember to untie the rope from the lift screw before attempting to detach the catcher from the sweeper.
2. Swept material can be carried in the catcher basket (with the sweeper in transport position), to a convenient location and easily dumped by pulling on the rope. Release the rope (F), and the catcher basket will return to its upright position.

when operating in wet grass

When sweeping grass that is wet or very damp and heavy, you may find that the grass is not thrown all the way to the rear of the catcher. This may be improved by removing the discharge guide panel (refer to Fig. 2, page 2), above the brush opening. This panel serves to deflect the swept material and prevent throwing material over the top of the catcher basket. It is most effective when sweeping dry leaves and dry grass clippings.

Also, when sweeping wet or damp, heavy grass, there may be a buildup of material on the sweeper throat extension (refer to Fig. 1, page 1), below the brush opening. This happens because the heavy grass is not thrown high enough and it catches on the edge of the throat extension. If this is hampering the operation of the sweeper, the extension may be removed. The operation of the sweeper should be quite satisfactory after removal of the extension.

for sweeping sidewalks, driveways, etc.

To lower the sweeper enough to sweep the surface of a sidewalk, driveway, etc.

1. Follow step 1, page 3.
2. Lower the sweeping height by turning the handle of the lift screw (B, Fig. 9), counter-clockwise. Adjust until tips of the brush touch the surface. Begin sweeping and make fine adjustments in height until the sweeper goes a satisfactory job. Remember to raise sweeper to regular operating height before beginning yard work.

operating (cont.) lift links adjustment

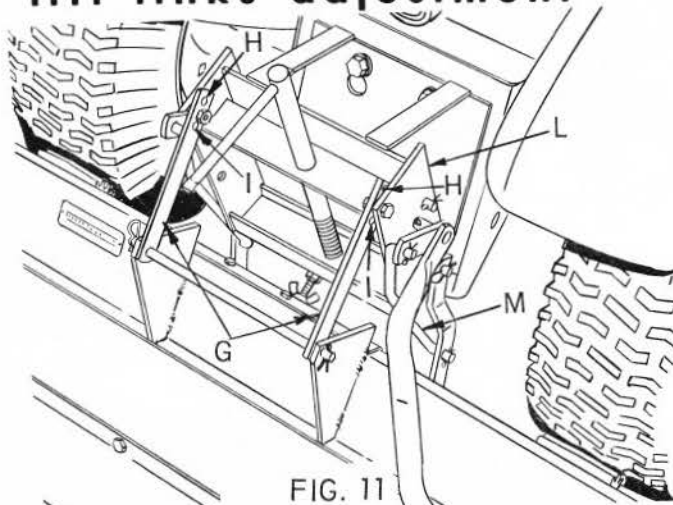

FIG. 11

For normal operation the lift links (G), should be assembled in the middle hole as shipped from the factory. They do however, have two additional holes at the point where they are attached to the lift slide frame. These holes provide the following adjustments:

1. If the surface to be swept is uneven and the bottom of the catcher is dragging on the ground occasionally as the sweeper is operated, the rear of the catcher can be raised a small amount by attaching the lift links (G), in hole (I).
2. If the sweeper is mounted on your tractor and the catcher is at a fairly steep angle with the ground when the rollers are against the tractor tires, the catcher can be lowered a small amount by attaching the lift links (G), in hole (H).
3. If there is difficulty in obtaining enough roller-tire contact pressure on your tractor be sure that the contact stop bolt (D, Fig. 8, page 3), is turned in to allow 1/8" clearance between the head of the bolt and the stop. The rollers can be brought closer to the tractor tires by attaching the lift links (G), in hole (I).

edge plate assembly

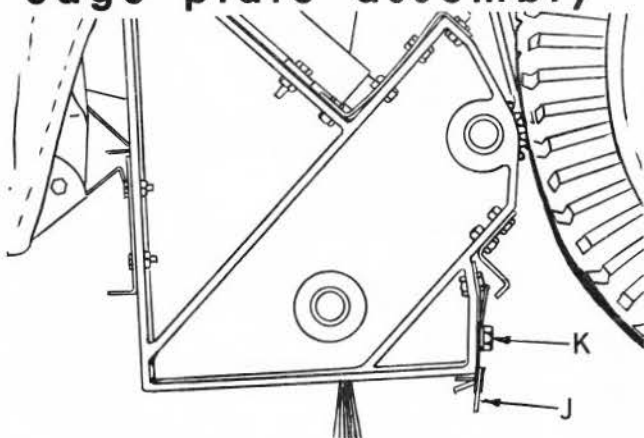

FIG. 12

The edge plate assembly with the rubber strip (J), located at the front of the sweeper may be adjusted up or down by loosening the bolt (K), at each end. The purpose of this strip is to prevent the brush from throwing a large amount of material forward as the sweeper is operated. The edge plate assembly may be removed if too much material is dragging in front of it when sweeping.

how to remove sweeper

If it is necessary to use the drawbar of the tractor to pull a cart, etc., this can be done two ways.

1. The sweeper basket can be removed by grasping the upper bag tubes on each side and pulling up and back. This will disengage the support tubes from the tube brackets. Do not forget to untie the rope from the lift screw and handle. The sweeper is then removed from the hitch by removing the retainer springs and the rods located in the lift links and lift brackets. Remove the cotter pin and the washer at the lower end of the lift screw. Grasp the handle of the lift screw and raise the lift slide until a small hole is visible above one of the two large holes in the slide plate. Insert a 3/8" x 3/4" hex bolt into this hole and attach a nut to retain the bolt, or insert a short drilled rivet and attach with cotter pin. Lower the lift slide until it rests on the bolt or the drilled rivet. The lift screw may be adjusted upward to provide more clearance over the drawbar hole. When using the drawbar of the tractor to pull a cart, etc. the lift handle will tend to fall down and may get in the way. When the lift lever is moved to the raised position, two holes are exposed in the slide frame (L, Fig. 11), behind the lift link (M, Fig. 11). With the lift handle in the raised position, insert the lower lift attachment rod (longest rod), in the two exposed holes behind the lift link (M, Fig. 11). Secure with retainer spring. This will prevent the lift handle from dropping down.
2. The second approach would be to remove the hitch from the tractor drawbar completely by removing the cotter pin and washer from the lower end of the lift screw and then loosening the four bolts holding the hitch to the tractor drawbar. After the bolts are loose, the hitch can be slid upward and removed. Then remove the four bolts to insure that they will not be lost.

maintenance

To maintain the sweeper in good operating condition it is advisable to do the following:

1. Check the hitch, sweeper and catcher basket periodically for loose nuts and bolts, screws and missing cotter pins.
2. Check and tighten if necessary, set screws in drive sprockets.
3. Oil shaft bearings and drive chain every month during operating season, or as often as necessary. Use regular S. A. E. motor oil.
4. Clean basket and sweeper after each use to eliminate buildup of dirt and debris.
5. Check tightness of brushes and brush adjustment before operating. The metal strip on each brush should be attached to the shaft so that the end of the metal strip is about 1/8 inch from the casting at the ends of the sweeper. This should be checked and readjusted if necessary.

notes

another free manual from www.searstractormanuals.com

repair parts

LITTER-WHISK
MODEL NO.
917.253440

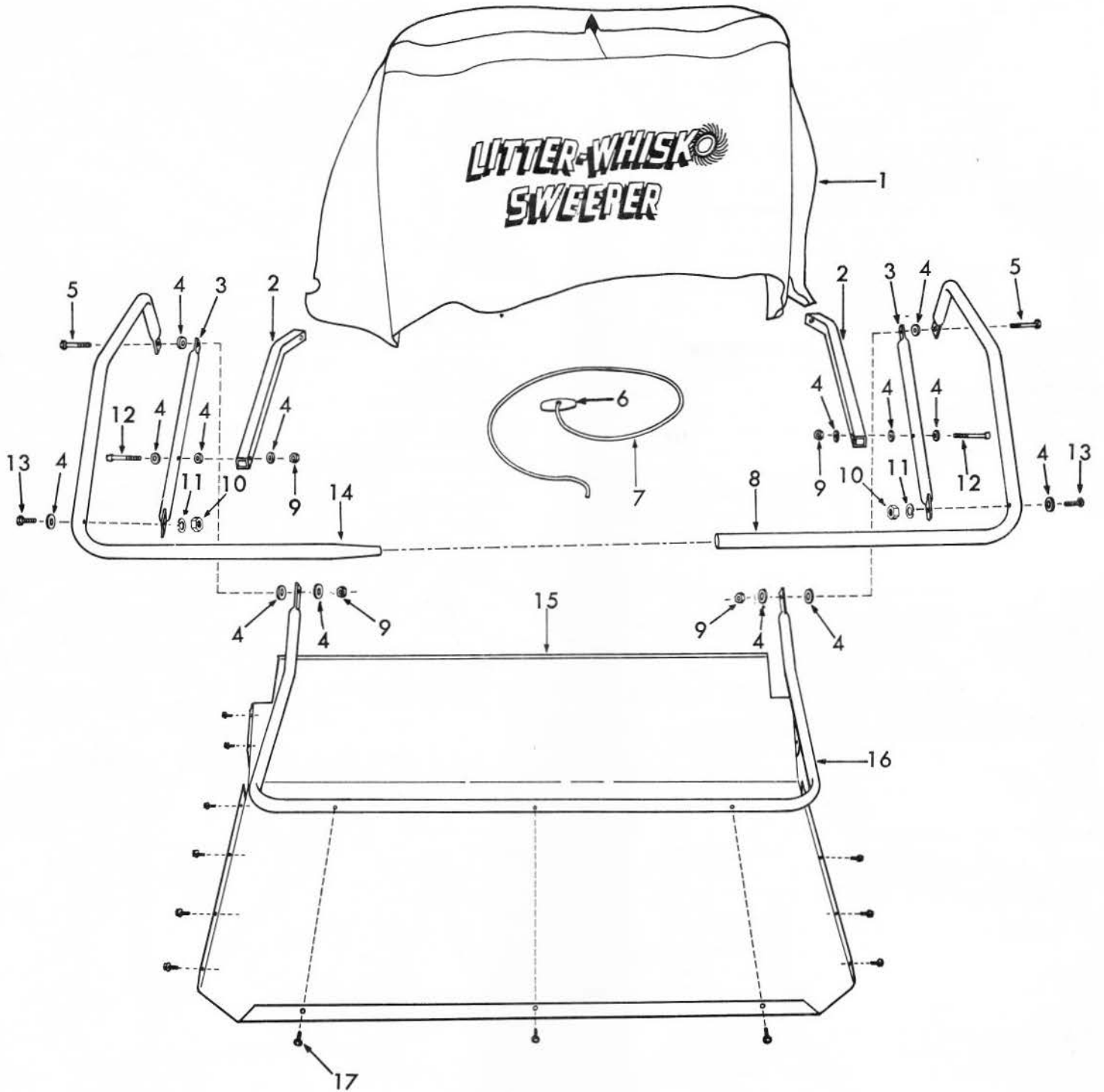

another free manual from www.searstractormanuals.com

repair parts

LITTER-WHISK
MODEL NO.
917.253440

KEY NO.	PART NO.	DESCRIPTION
1	2375R	Catcher Bag (Basket)
2	2346R	Support Tube
3	2344R	Pivot Tube
4	1505P	Washer 9/32 x 1/2 x 14 Ga.
5	3004P	Hex Bolt 1/4 - 20 UNC x 1
6	2377R	Dump Rope Handle
7	2376R	Dump Rope
8	2343R	Bag Tube - Upper-R.H.
9	1605R	Gripco Nut 1/4 - 20 UNC
10	503P	Hex Nut 1/4
11	1002P	Lockwasher 1/4
12	3258P	Hex Bolt 1/4 - 20 UNC x 2 1/2
13	3117P	Hex Bolt 1/4 - 20 UNC x 1 1/2
14	2342R	Bag Tube - Upper-L.H.
15	2365R	Catcher Bottom
16	2341R	Bag Tube - Lower
17	5504P	Slotted Hex Hd. Self Tapping Screw, Type AB #10 - 32 UNC x 3/4
---	2384R	Owners Manual

repair parts

LITTER-WHISK
MODEL NO.
917.253440

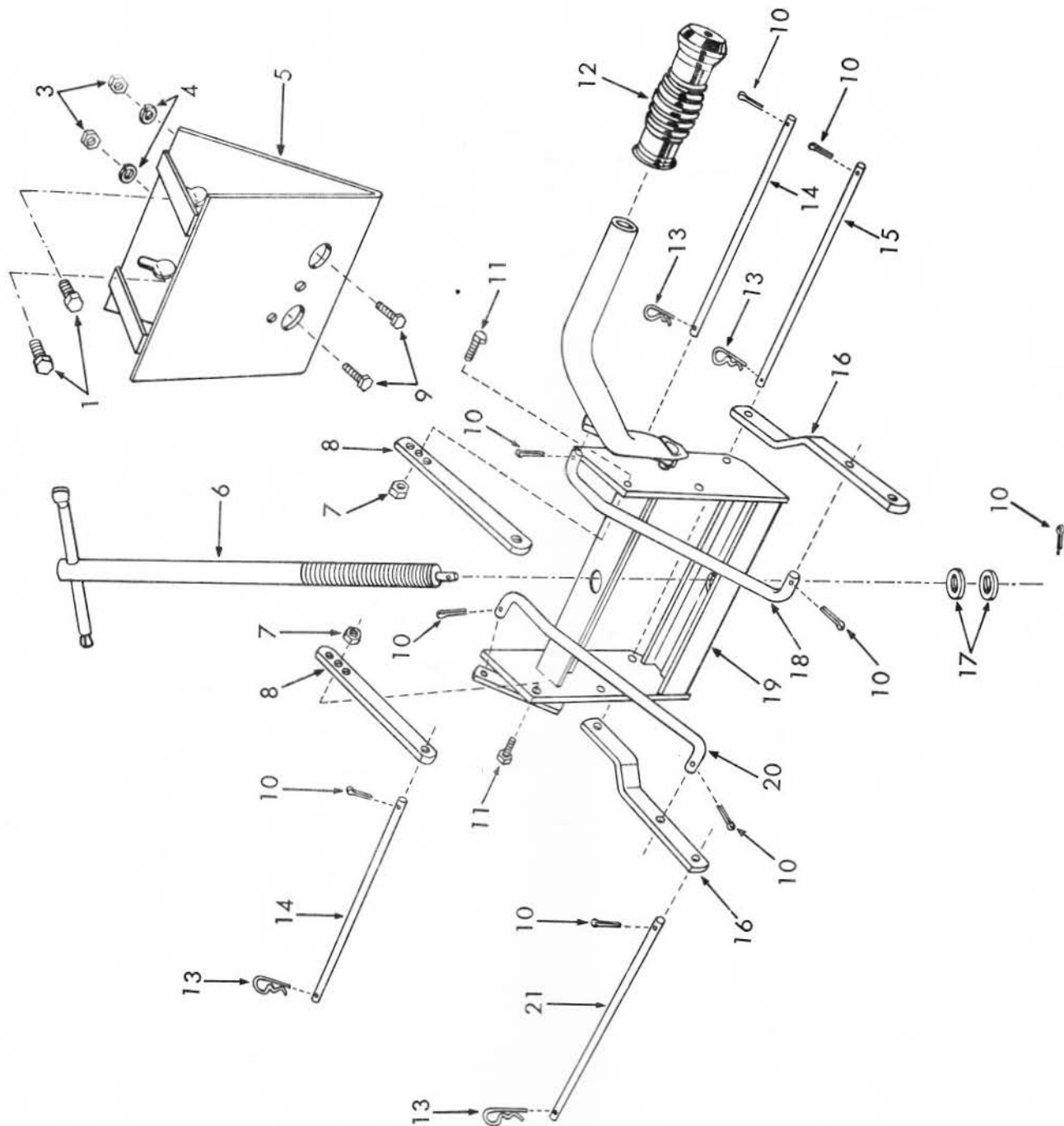

another free manual from www.searstractormanuals.com

repair parts

LITTER-WHISK
MODEL NO.
917.253440

KEY NO.	PART NO.	DESCRIPTION
1	3044P	Hex Bolt $\frac{1}{2}$ - 13 UNC x $1\frac{1}{4}$
3	501P	Hex Nut $\frac{3}{8}$ - 16 UNC
4	1004P	Lockwasher $\frac{3}{8}$
5	661A19	Lift Guide Weldment
6	661A20	Lift Screw and Handle
7	1685H	Gripco Nut $\frac{5}{16}$ - 18 UNC
8	2351R	Lift Link-Upper
9	3025P	Hex Bolt $\frac{3}{8}$ - 16 UNC x $1\frac{1}{4}$
10	2506P	Cotter Pin $\frac{1}{8}$ x 1
11	3011P	Hex Bolt $\frac{5}{16}$ - 18 UNC x 1.
12	4938H	Handle Grip
13	4939M	Retainer Spring
14	2332R	Attachment Pin Upper
15	2331R	Lower Slide Pin
16	2352R	Lift Link-Lower
17	1513P	Washer $\frac{13}{32}$ x $\frac{13}{16}$ x 16 Ga.
18	2335R	Lift Rod-R.H.
19	661A18	Lift Weldment
20	2336R	Lift Rod-L.H.
21	2333R	Attachment Pin Lower

repair parts

LITTER-WHISK
MODEL NO.
917.253440

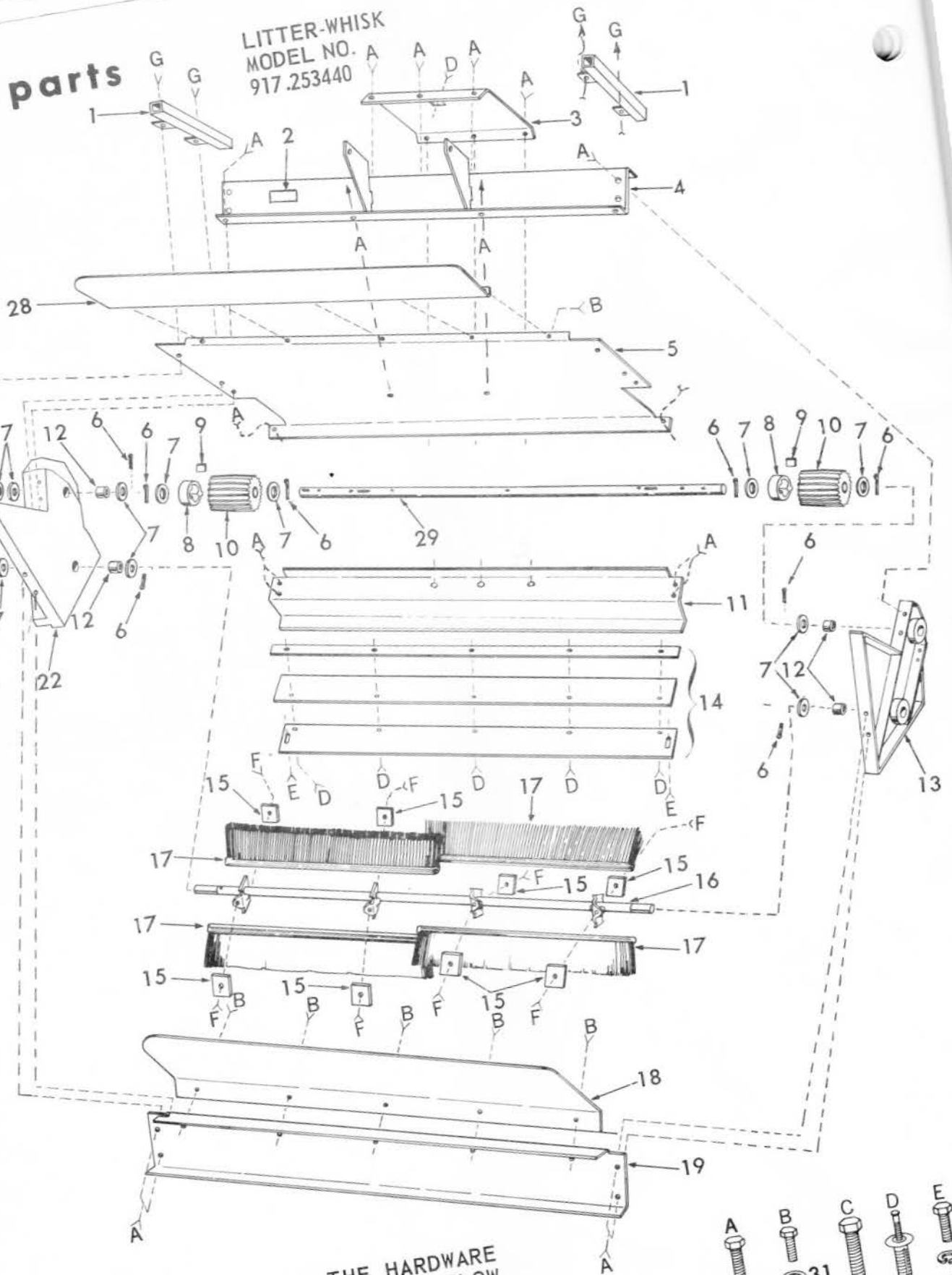

THE LETTER ABOVE THE HARDWARE INDICATES THAT ITEM AND ANY BELOW IT ARE USED IN THE LOCATION IN THE MAIN DRAWING WHERE THE IDENTICAL LETTER APPEARS. EACH ITEM OF HARDWARE MUST BE ORDERED INDIVIDUALLY.

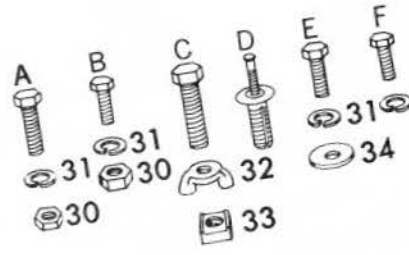

repair parts

LITTER-WHISK

MODEL NO.

917.253440

KEY NO.	PART NO.	DESCRIPTION
1	661A12	Support Tube Slide Weldment
2	4010R	Model Plate
3	2369R	Reinforcement Plate
4	661A14	Upper Lift Weldment
5	2361R	Main Panel
6	2507P	Cotter Pin 1/8 x 1 1/4
7	1552P	Washer 49/64 x 1 1/4 x 16 Ga.
8	4009R	Ratchet Cog
9	4007R	Ratchet Link
10	4008R	Drive Roller
11	661A15	Lower Lift Weldment
12	4156R	Bearing
13	66TA17	Right End Casting and Bearings (Inc. Key #12)
14	661A11	Edge Strip Assembly (Inc. Key Letter E)
15	2353R	Brush Clamp Strap
16	661A21	Brush Shaft Weldment
17	2380R	Brush
18	2363R	Sweeper Throat Extension
19	2367R	Rear Channel
20	2382R	Drive Chain
21	4533P	Set Screw, Sq. Hd. C.P. 1/4-20 x 3/8
22	661A16	Left Hand Casting and Bearings (Inc. Key #12)
23	7835M	Woodruff Key 1/8 x 1/2
24	2378R	Sprocket
25	4534P	Set Screw Sq. Hd. C.P. 1/4-20 x 5/8
26	2379R	Sprocket
27	2362R	Casting End Plate
28	2364R	Discharge Guide Panel
29	4006R	Drive Shaft
30	503P	Hex Nut 1/4
31	1002P	Lockwasher 1/4
32	551P	Wing Nut 3/8-16
33	2388R	Speed Grip Nut Retainer
34	1505P	Washer 9/32 x 1/2 x 14 Ga.
A	3003P	Hex Bolt 1/4-20 x 3/4
B	3114P	Hex Bolt 1/4-20 x 1/2
C	3259P	Hex Bolt 3/8-16 x 3 Full Thread
D	2513R	Drive Rivet
E	3114P	Hex Bolt 1/4-20 x 1/2
F	5552P	Hex Hd. Thrd. Cutting Screw 1/4-20 x 5/8
G	3004P	Hex Bolt 1/4-20 x 1

another free manual from www.searstractormaterials.com

notes

notes

another free manual from www.searstractormanuals.com

661W7

661W8

Sears

**owners
manual**

The Model Number will be found on a plate attached to the Upper Lift Weldment. Always mention the Model Number when requesting service or repair parts for your Litter-Whisk.

All parts listed herein may be ordered through SEARS, ROEBUCK AND CO. or SIMPSONS-SEARS LIMITED. When ordering parts by mail, selling prices will be furnished on request or parts will be shipped at prevailing prices and will be billed accordingly.

WHEN ORDERING REPAIR PARTS, ALWAYS GIVE THE FOLLOWING INFORMATION AS SHOWN IN THIS LIST.

1. The PART NUMBER
2. The PART DESCRIPTION
3. The MODEL NUMBER
917.253440
4. The NAME OF ITEM—
Litter-Whisk



When you buy merchandise from Sears you get an extra something that nobody else can offer . . . Sears Service.

Across town or across the country, wherever you live or move in the U.S.A., Sears Service follows you, providing trustworthy, competent service technicians using only Sears specified factory parts.

**SEARS SERVICE
IS AT YOUR SERVICE
WHEREVER YOU LIVE
OR MOVE
IN THE U.S.A.**

Sears, Roebuck and Co., Chicago, Ill. 60607 U.S.A.
and Simpsons Sears Limited, Toronto

Dear Customer:

Sears has revised the form of the warranty covering your new Tractor Attachment in accordance with the recently enacted Magnuson-Moss Warranty Act. The revised warranty covering the Tractor Attachments you purchased is stated below. It replaces the warranty which may be stated on the label affixed to the product or in your owners manual.

FULL ONE YEAR WARRANTY ON TRACTOR ATTACHMENT

For one year from date of purchase, Sears will repair any defect in material or workmanship in the tractor attachment, at no charge.

If the tractor attachment is used for commercial or rental purposes, this warranty applies for only thirty days from date of purchase.

Service under this warranty is available by contacting the nearest Sears store or Service Center throughout the United States and Canada.

SEARS, ROEBUCK AND CO.
Simpsons-Sears, Ltd.

If you have any questions about this revision, please call the Customer Service Department in your local Sears store.

8497R-6.10.75